

1. SI50xxx

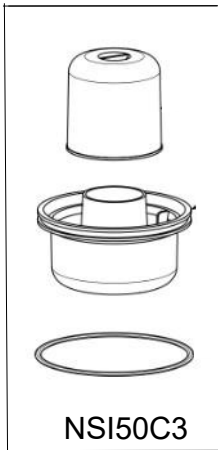

2. SI5Pxxx

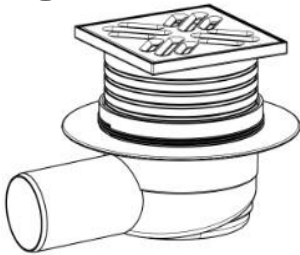
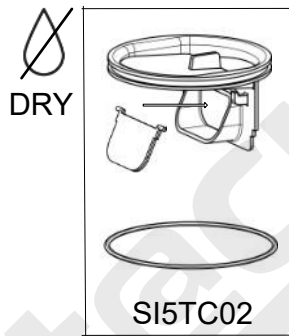
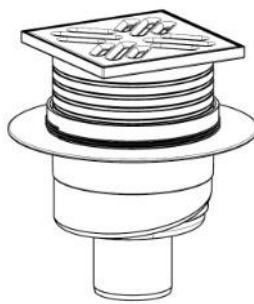

3. SI5Txxx

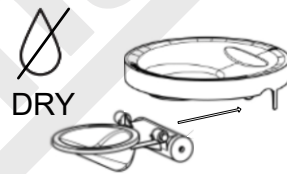

SI5TG02

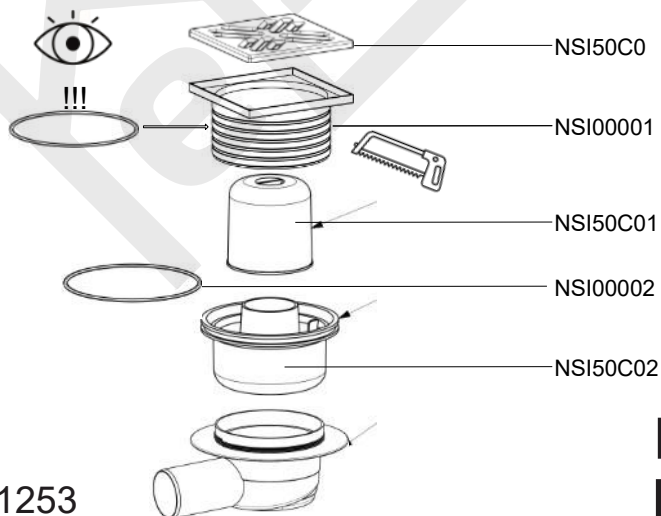

EN 1253

Max. 95
Material: ABS



Plast Brno, spol. s r.o., Jamní 934/42, 614 00 Brno Czech Republic

www.plastbrno.cz

Tel: +420 545 242 466, email: info@plastbrno.cz

